

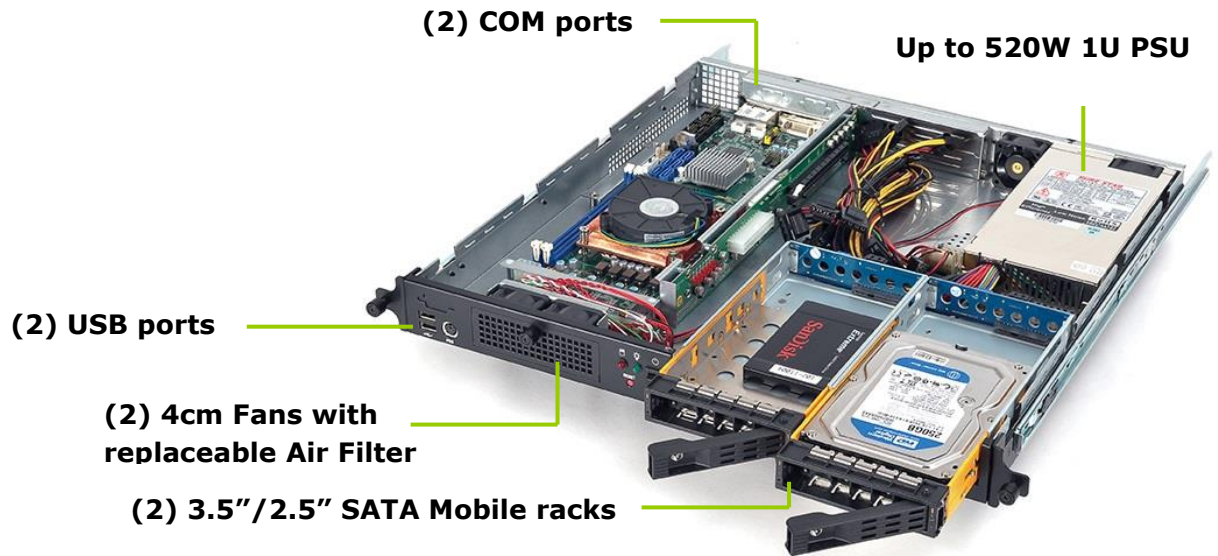

**1U Rackmount Chassis for SBC board with
3 drive bays, PICMG 1.3 backplane,
supports up to 520W PSU**



Introduction

The **RCK-103BR2** is an extended version of RCK103BR with a depth of only 435.5mm, it provides an ideal solution for those applications where depth can make or break a project. The chassis is designed to support a PICMG 1.3/ 1.0 Backplane and SBC, the RCK-103BR1 proves to be a perfect choice for sub-racks and short rack cabinets. The RCK-103BR1 can support (2) hot swap 3.5"/2.5" and (2) 2.5" SATA drives. Additional I/O expansion can be easily configured through the (1) PCIe or (3) PCI slots on the PICMG backplane. Total of three 4cm ball-bearing fans ensure excellent airflow when faced with a heat sensitive application. The **RCK-103BR2** provides a robust solution to Firewall Server, Proxy Server, and VPN Gateway while still remaining compact.

Features

- Heavy-duty Steel construction with only 435.5mm in depth
- Supports full-size SCB through PICMG1.3 butterfly backplane
- (2) 3.5"/2.5" SATA mobile racks, (2) int. space for 2.5" HDD/SSD
- (2) USB and (1) PS/2 ports
- RS-232 port on front and rear panel
- (3) 4cm ball-bearing fans with replaceable air filter
- Support up to 520W 1U PSU
- Full extension Slide rail included



Mechanical Drawing

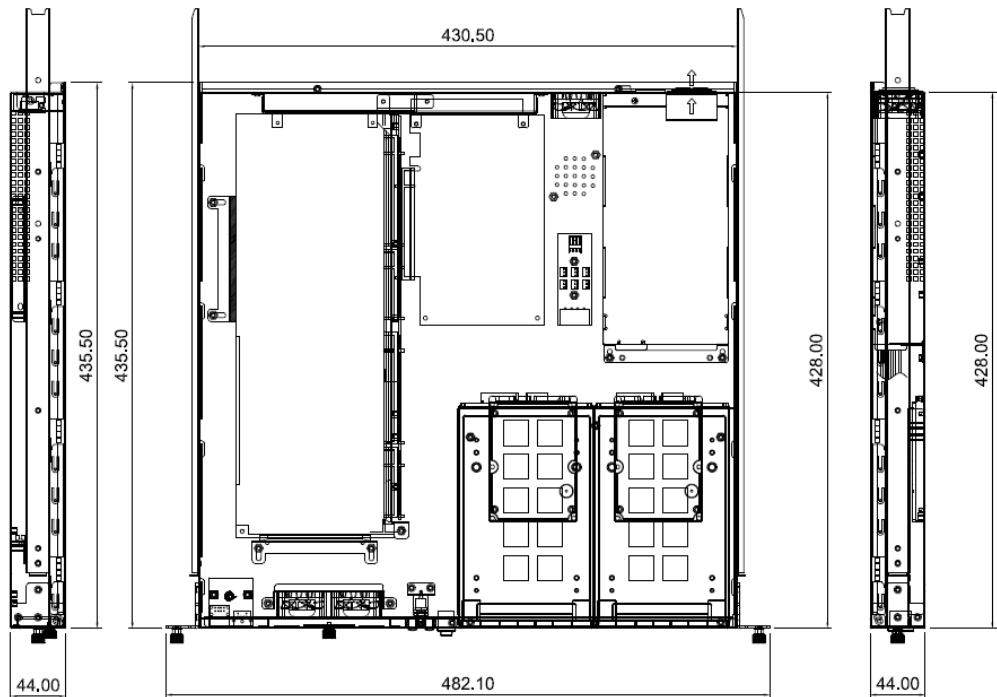

Construction

- Heavy-duty steel

Color

- Black

Board support

- Single Board Computer

Drive bays

- (2) 3.5"/2.5" SATA Mobile racks
- (2) internal space for 2.5" HDD/SSD

Expansion

- BPE-201E: Backplane with (1) PCIe x16 slot

Power Supply

- 300W/ 460W/ 520W 1U ATX PSU

Cooling System

- (3) 40mm ball-bearing fans with replaceable air filter

I/O Port

- (2) USB 2.0 port
- (1) front and (2) rear RS-232 port

Switch

- Power On/Off and Reset switches

Indicator

- Power On/Off and HDD activity LEDs

Operating temperature

- 0~55°C

Dimension (W x D x H)

- 430.5 x 435.5 x 44mm

Weight

- NW: 5kg / 11.1lbs
- GW: 8.8kg / 19.4lbs

Ordering Information

RCK-103BR2-201E-BLK	1U chassis for SBC board with BPE-201E backplane
RCK-103BR2-201E-300W-BLK	1U chassis for SBC board with BPE-201E backplane and 300W PSU
RCK-103BR2-201E-460W-BLK	1U chassis for SBC board with BPE-201E backplane and 460W PSU



Industrial Full-size PICMG 1.3 SBC supports 8th Generation Intel® Core™ Processors with Intel® C246/Q370/H310 PCH, SATA3, M.2 Key, USB 3.1, Dual LAN and DVI-I



Features

- Supports Intel 8th Gen. Core Processors
- Dual Gigabit Ethernet supported
- (6) SATA-600 with RAID 0/1/5/10 (C246/Q370)
- Watchdog & Hardware Monitor function
- Supports Intel® AMT and vPro (C246/Q370)

CPU

- LGA1151 for 8th Generation Intel® Core™ Processors

Chipset

- Intel® C246/Q370/H310

System Memory

- (2) 288-pin DDR4 2400/2666 un-buffered DIMM max. up to 32GB (C246 supports ECC)

Display Interface

- Intel® HD Graphics
- (1) DVI-I

Ethernet

- 1st port with Intel® i219LM with AMT 11 support
- 2nd port with Intel® i211AT
- support WOL,RPL/PXE Boot ROM

Audio

- Optional Audio Codec with external module

TPM

- Optional TPM 2.0 module

I/O Interface

- (2) RS232 & (2) RS232/422/485 serial ports
- C246/Q370: (2) USB 3.1 Gen.2 & (4) USB 3.1 Gen.1, (4) USB 2.0 Ports
- H310: (4) USB3.1 Gen. 2 & (4) USB 2.0 Ports
- C246/Q370: (6) SATA-600 support RAID 0/1/5/10
- H310: (4) SATA-600
- M.2 Key M 2280, PCIe x4 signal
- (1) PS/2 keyboard & (1) PS/2 mouse & (1) LPT

Expansion Interface

- Edge Connector A: (1) PCIe x16, Gen. 3 Edge Connector B: (1) PCIe x4 or (4) PCIe x1, Gen. 2
- (4) 32 bit PCI bus masters

Environment Spec

- 0 ~ 60°C operation temperature
- Operation humidity under 10% ~ 95%

Dimension

- 338mm x 126mm

Ordering Information

SBC-6511 2GND-Q	LGA1151 Socket 8th Generation Intel® Core™ processors, Intel® Q370 PCH, USB 3.1, SATA 3.0. Dual LAN, DVI-I
SBC-6511 2GND-C	Intel® C246 PCH
SBC-6511 2GND-H	Intel® H310 PCH
AAC-93242	Optional Audio Kit